

FIRST ANGLE PROJECTION

ALL DIMENSIONS ARE IN mm.

REV 10
 CT14C E1 786 E
 DRG No.

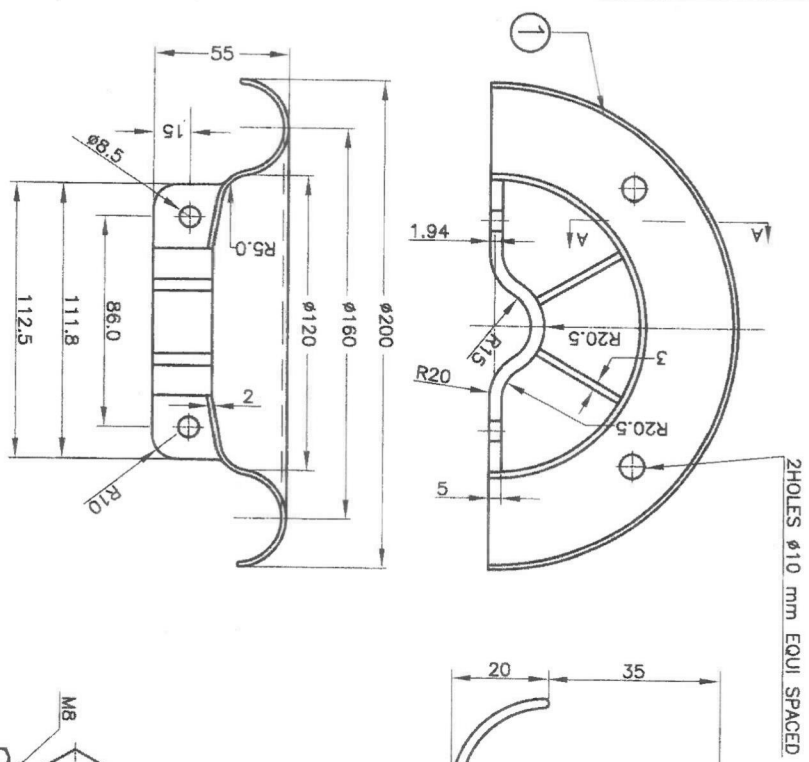

NOTES :

1. MATERIAL: ALUMINIUM ALLOY CONFIRM TO DESIGNATION GR. 4600.
2. CORONA RING PRESSURED DIE CASTING, MUST BE SMOOTH FINISH.
3. UNTOLERANCED DIMENSIONS ARE MAINTAINED WITHIN $\pm 1\%$.
4. UNSPECIFIED RADII ARE 1mm.

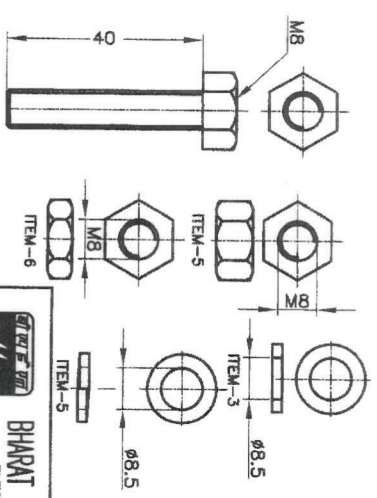
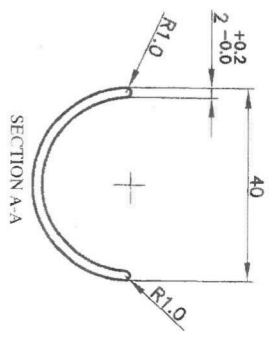
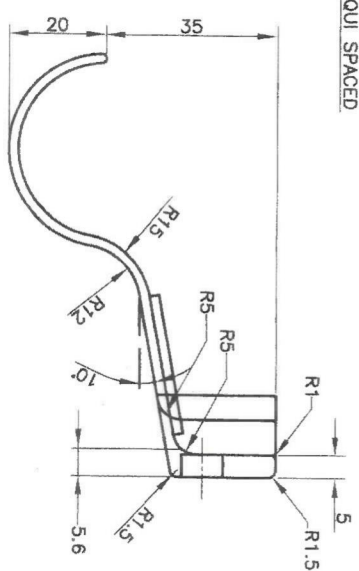

Assembly of 2 halves

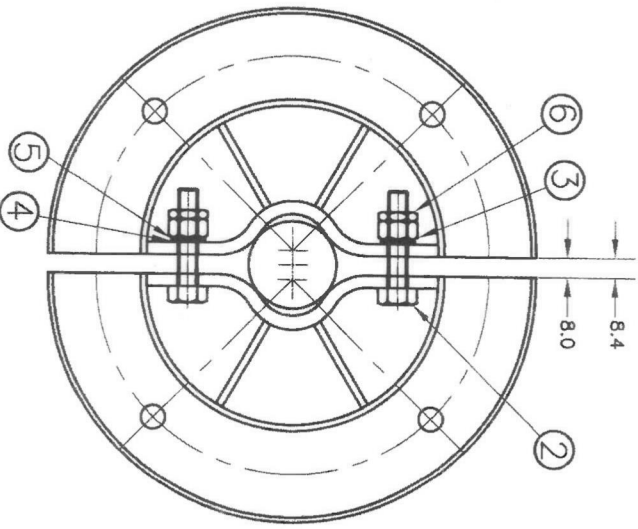

REV	DATE	ALTERED	REV	DATE	ALTERED
CHECKED			CHECKED		

CONTROLLED COPY

REV	DATE	ALTERED BY	REV	DATE	ALTERED BY
01	06.03.2018	CHECKED & REDRAWN			

1. DRAWING REVISED & REDRAWN
 2. NOTE 2 ALTERED
 3. ITEM NO 1 ALTERED IN BOM

REF:PH:5898

ITEM No.	DESCRIPTION	MATERIAL	QTY.
6	LOOK NUT	STAINLESS STEEL ASI 304	2
5	SPRING WASHER	SPRING STEEL(GALVANISED)S:4072&3063	2
4	PLAIN WASHER	STEEL Fe-410, IS:2062	2
3	HEX. NUT	STAINLESS STEEL ASI 304	2
2	HEX. BOLT	STAINLESS STEEL ASI 304	2
1	RING 1 HALF	ALUMINIUM ALLOY	2

DEPT GRADE OF TOL DIM C/M/F

SCALE WEIGHT (kg) REF TO ASSY.DRG

ITEM No. 018 (Approx)

REV. 01

DRWG No. 3 987 14 34123

REV. 01